

ROOF FRAMING

ROOF SLOPE IS 4 IN 12

ROOF JOISTS:
2X12 SPF SPACED AT 24" O/C
ROOF JOISTS TAILS CUT TO 5-1/2"

RIDGE BOARD

2X10 SPF
WILL REST ON RIDGE BEAM AND BE SECURED WITH NAILS OR SIMPSON HARDWARE
WILL PROJECT BEYOND EXTERIOR WALLS TO FASCIA WITH A REDUCTION IN THICKNESS,
TO MATCH THE REST OF SOFFIT FRAMING.

EAVE AND SOFFIT FRAMING:

GABLE END PROJECTIONS WILL BE MADE USING 2X12 REDUCED IN THICKNESS TO 5-1/2",
SPACED 16" O/C, AND CANTILEVERED WITH AT LEAST 2 FT OF BACK SPAN.
END GRAIN OF RAFTER TAIL AND GABLE PROJECTION FRAMING WILL BE SEALED
FROM MOISTURE WITH SELF PRIMING SPRAY PAINT.

SOFFIT OVERHANG DISTANCE:

WHERE A GUTTER IS NOT PRESENT OVERHANG TO BE 24" TO FINISHED FASCIA.
WHERE EAVES SUPPORT A GUTTER, OVERHANG TO BE 18" TO FINISHED FASCIA.
AT THE HIGH END OF "SHED STYLE ROOF SECTION" OVERHANG WILL BE HELD BACK
THE THICKNESS OF FASCIA ASSEMBLY SO THAT THE FINISHED FASCIA PLANES IN-LINE
WITH THE CENTER OF THE GABLE END ROOF, WHICH IT INTERSECTS

ROOF MOISTURE PROTECTION & INSULATION:

ROOF SPACE VENTING REQUIREMENTS:

WILL BE MET USING VENTED ROOF JOIST CAVITIES AND 2X4 PURLINS, WHICH WILL
ALLOW AIR TRAVEL IN ALL DIRECTIONS BENEATH ROOF SHEATHING
A TOTAL GAP FROM INSULATION TO UNDERSIDE OF SHEATHING OF 2-1/2" BE ACHIEVED
USING A COMBINATION OF PURLINS AND HOLDING THE INSULATION BACK THE REMAINING
DISTANCE.

ROOF VAPOR BARRIER:

THE AIR TIGHTNESS OF THE POLYETHYLENE BARRIER IS ESSENTIAL IN THIS VAULTED
CEILING ASSEMBLY. TAPE, CAULK AND SPRAY FOAM WILL BE USED TO SEAL ALL
PENETRATIONS.

ROOF INSULATION:

THE ROOF WILL BE INSULATED WITH F.G. BATT INSULATION SPACED 1" (MIN) OFF THE
UNDERSIDE OF ROOF SHEATHING. ADDITIONAL SITE-MADE RIGID FOAM BAFFLES MAY
BE USED TO HELP ENSURE THE GAP.

ROOFING UNDERLAYMENT:

ROOF IS TO BE COVERED WITH ROOFING UNDERLAYMENT WHICH MUST EXTEND A
MINIMUM OF 36" UP THE ROOF SLOPE AND 12" FROM INNER FACE OF EXTERIOR WALL
STARTER STRIP OF UNDERLAYMENT WILL BE USED BENEATH ANY FLASHINGS AND
GUTTERS, AND THEN ANOTHER LAYER POSITIVELY LAPPED ON TOP OF FLASHING AND
GUTTERS.

ASPHALT SHINGLES:

A STARTER STRIP WILL BE USED IN ACCORDANCE WITH 9.26.7.2
A 2" HEAD LAP (MIN) WILL BE USED

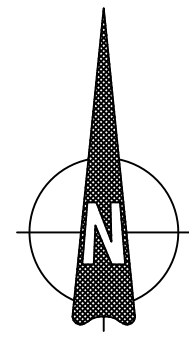
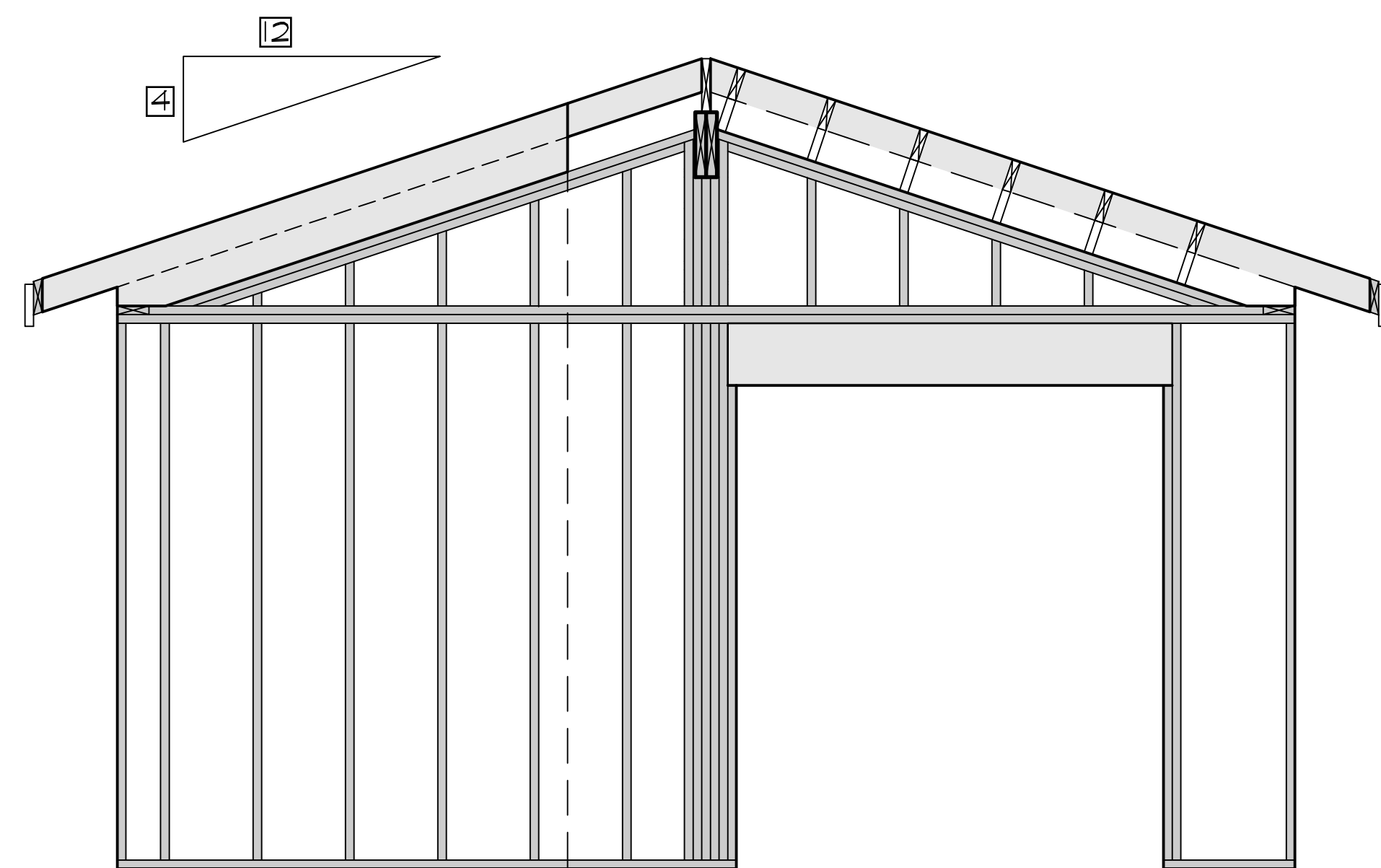

MOORE TOM MORRISON
250 866-2685 JSK22Y@GMAIL.COM

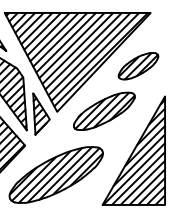

COMMENTS

NO DATE

NO DATE

1454 BEGGIE STREET

VICTORIA BC, V8R 1K7

DATE 12.03.2021

SCALE 1/2" = 1'

STUDIO ACC. BUILDING

ROOF PLAN

~SHEET~

5

8